

Projects

Update for Planning Committee

- Cass Square
 - Toilets
 - Playground
 - Skate Park
- Hokitika Township
- Hokitika Beachfront

Cass Square Concept Plan

New pavilion will be in place of existing grandstand

New Toilet Complex

Additional vegetation to be added around park to enhance the setting

New Skatepark

New Playground

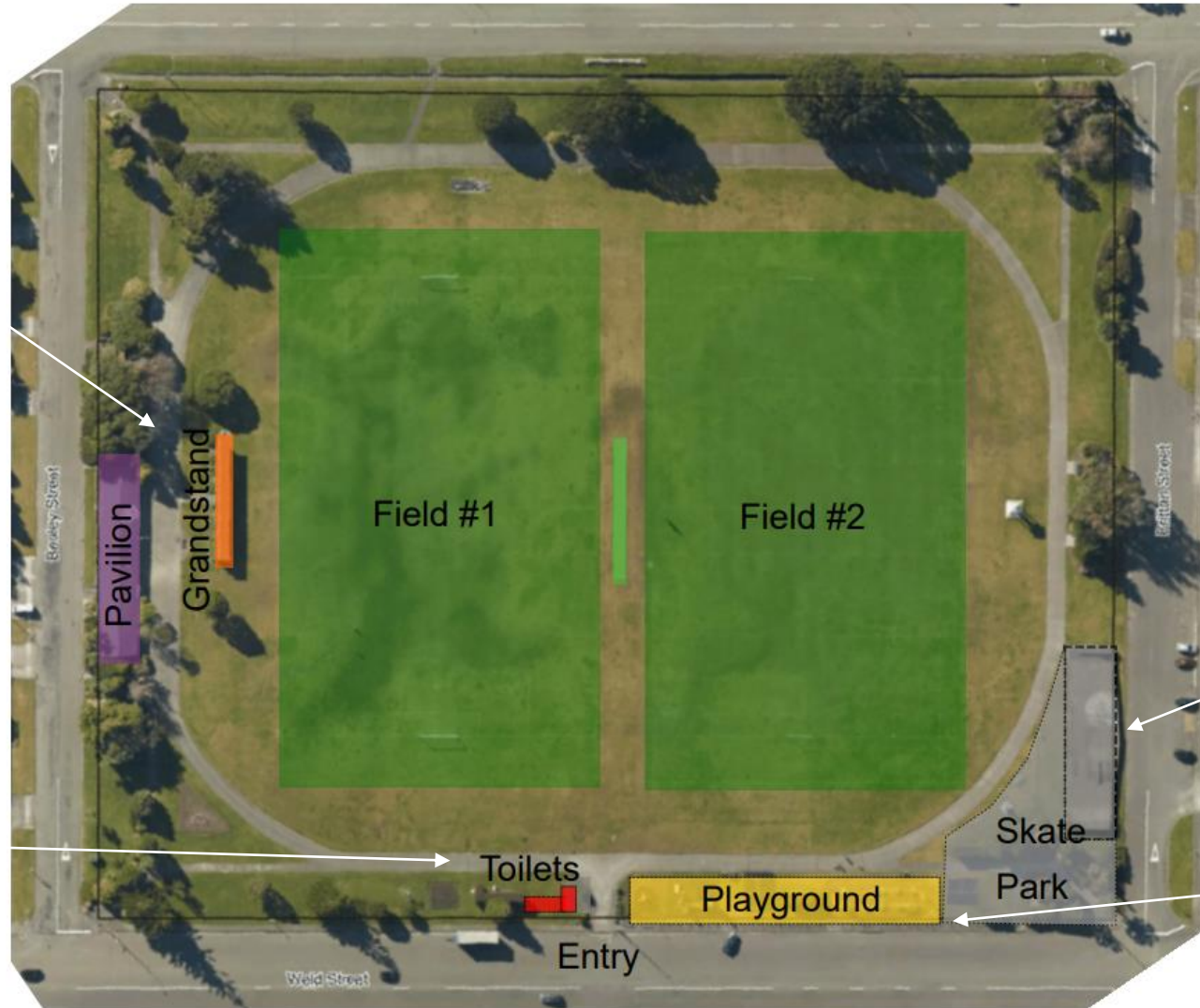

CASS SQUARE CONCEPT PLAN

Concept plan for Cass Square showing locations of new toilets, Playground and Skate park

24 Feb 2022 Drawn SE



New Toilet Complex



UPDATE

- Requested Consent to be lodged by designer
- Toilets ordered for delivery early May
- Intend to install immediately pending consent approval

FEATURES

- Similar design to other district toilets to promote consistency
- Features include shelter, e-bike charging stations and ability to install decoration or feature panels as required

New Skate Park Concept Design



UPDATE

- Location changed from along Brittan street to focused along Weld/Brittan street corner
- Concept still to be received

NEXT STEPS

- Receive concept design
- Lodge consent
- Installation next FY

SCOPE

- Engaged Dave North to provide concept designs
- Project brief included Lincoln Skate Park as concept idea
- Location of skatepark will provide opportunity to tidy up area

New Playground

Initial concept designs

Wobbly Wood Pohe Tower 8801

These huge towers (standing over 7m tall!) are the centre of operations at any playspace. Test your fear of heights, crawl along our rope net bridge suspended 5m in the air!! With multiple rope net structures, firepoles, wobbly log bridge, baskets swings, tube slides and much, much more excitement in store.

Wobbly Pohe Towers

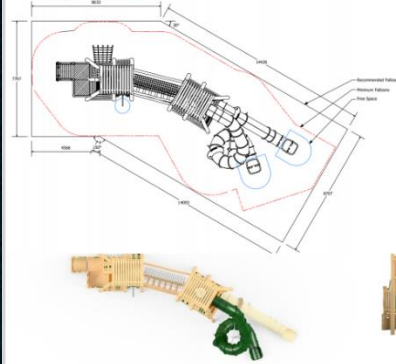

Indicative Package Price: \$619,676



Angled Hex Tower 8510 - Metal

We've ramped up our tower design, taking the concept further again with more angular shapes and posts, resulting in a fairy-tale style structure that immediately creates a sense of wonder. This awesome multi-tiered tower has two tube slides coming off at different platforms and a variety of activities for all ages



Indicative Package Price: \$410,339 + GST

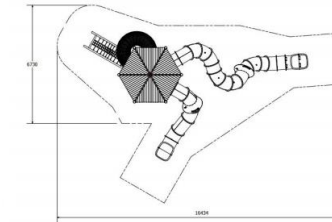

UPDATE

- Provided with number of unsuitable concept designs, currently awaiting further designs

NEXT STEPS

- Receive further designs and approve design for installation

SCOPE

- Engaged The Playground Centre to provide design and equipment
- Replace existing playground with a variety of age suitable equipment
- Include feature piece of equipment
- Equipment must provide for affordability of maintenance

Hokitika Township – Wayfinders

Modified Design

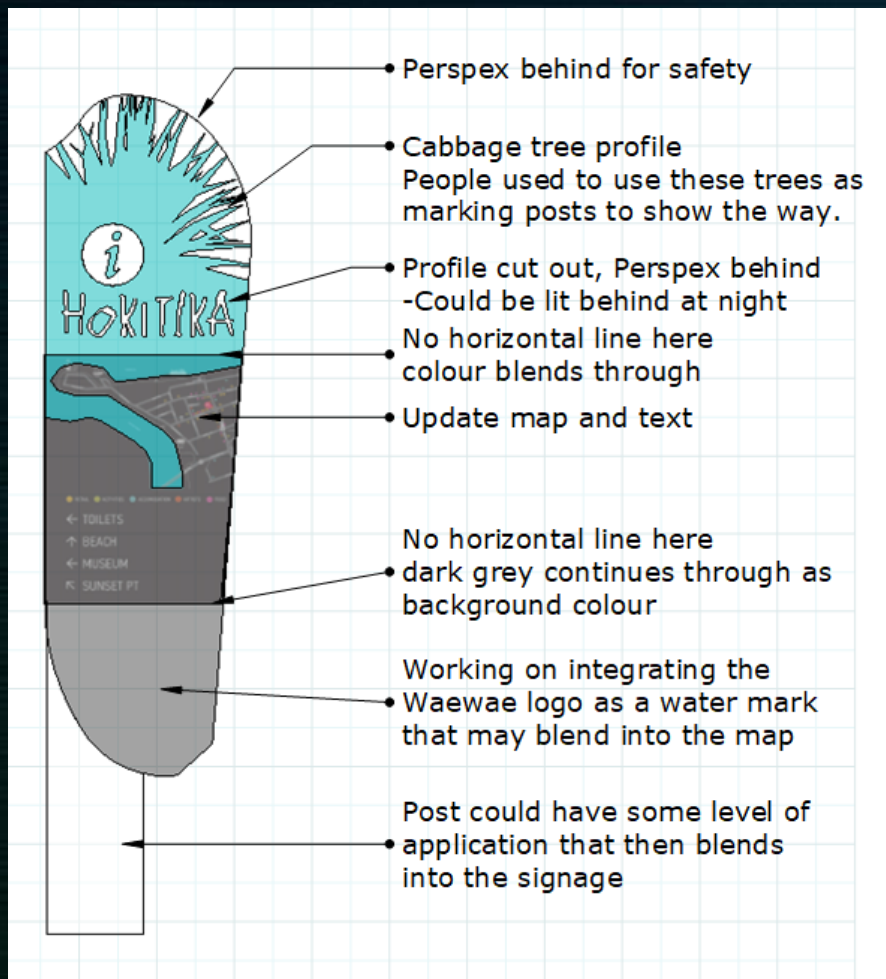

UPDATE

- Consulting with Ngati Waewae to redesign the shape to include inspiration from 'the way it use to be done' – signage by marking on Ti Kouka (cabbage) Tree and integrating the Waewae logo to tell a story

NEXT STEPS

- Approval from Ngati Waewae on new design
- Engage Signlink Graphics to make Wayfinders

SCOPE

- Original design not approved due to lack of cultural integration and size

Hokitika Beachfront

KEY

- Work stages completed
- Future work stages

1. Sunset point development
2. Dune establishment and landscaping
3. Landscaping and path development
4. Beach access ramp and landscaping
5. Car parking installation
6. Raise end, landscape and Install look out tower
7. Landscape and beautification
8. Gateway development, landscape and tidy
9. Park area establishment and car parking
10. Walkway extension to Richards drive



HOKITIKA BEACHFRONT DEVELOPMENT

Staged development plan

UPDATE

- Stage 1 – Complete – TIF/Local Share Funded
- Stage 2 – Complete – Locally Funded
- Stage 3 – Complete – Locally funded
- Stage 4 – Underway- Locally funded
- Stage 5 – Underway – TIF funded

NEXT STEPS

Decide next stage and apply for next round of TIF funding

Next Stage Options

- 6. Raise end of Sunset Point and Install look-out tower
- 7. Landscaping and beautification
- 8. Gateway development, landscaping and tidying
- 9. Park area establishment and car parking
- 10. Walkway extension to Richards Drive

Hokitika Beachfront – Beach Access Ramp (Stage 4)

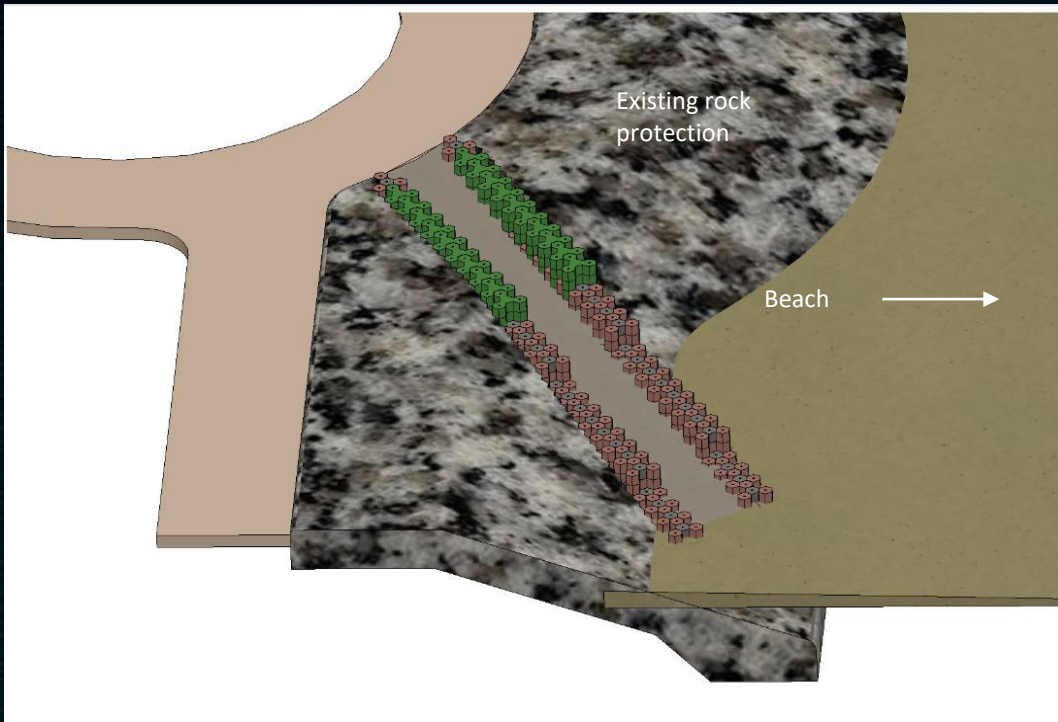

Update

- New beach access ramp to be constructed at the end of Weld Lane with permanent interlocking blocks (concrete)
- Contract has been released to tender
- West Coast Regional Council to fund and construct a new concrete retaining wall

ITEM NO.	DESCRIPTION	QTY.
1	Base Block	50
2	Standard Block	124
3	Cap Block	20
4	Top Block	34

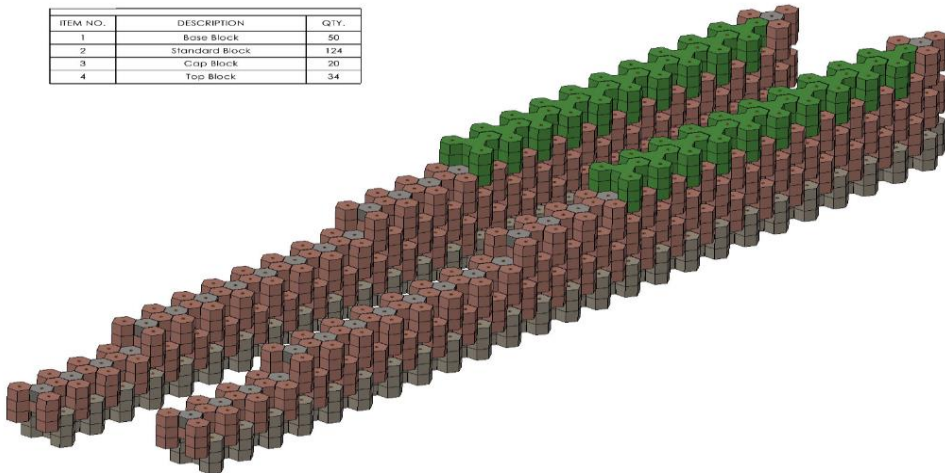

Hokitika Beachfront Carparking (Stage 5)

South end Beach Street x 2

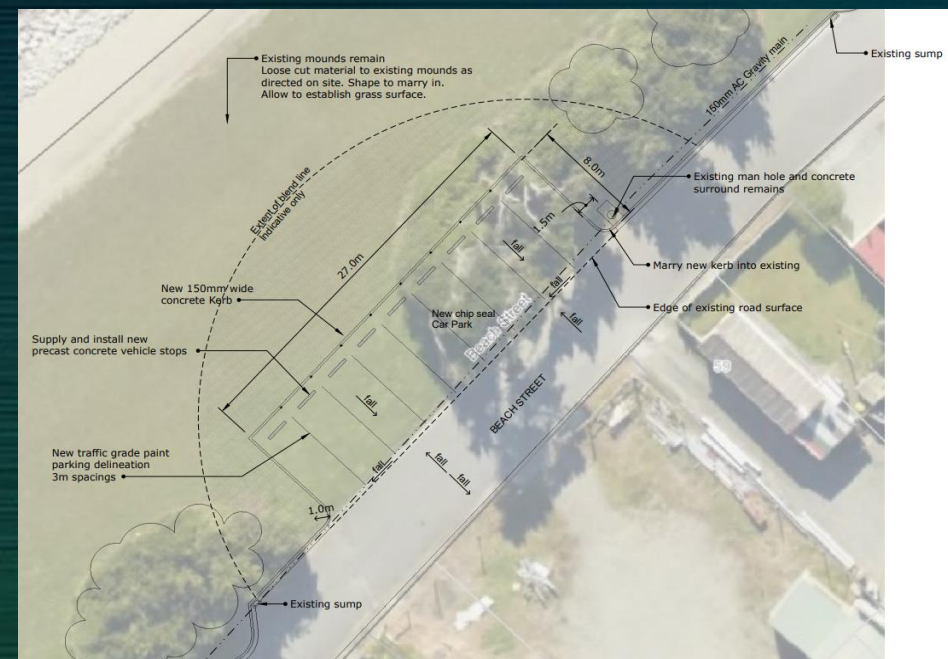
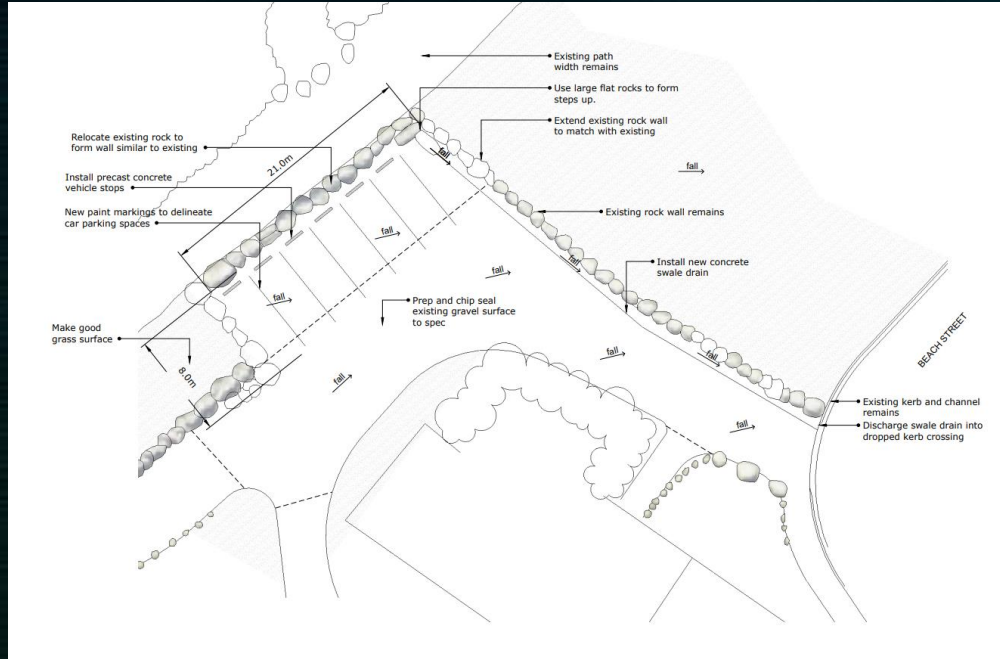

Upgrading the existing car parking at the end of Beach Street with increased parking spots, chip sealed ground and improved stormwater drainage. This includes the alignment of parking to allow better maneuvering.

Installation of new perpendicular car parks along beach street, south of existing toilets. Including kerbing and chip sealed. Grass area around the car park will be blended into the new kerb height. Soil material will be used around the site to form due like contours as already started with previous works.

Hokitika Beachfront Carparking (Stage 5)

Sunset Point

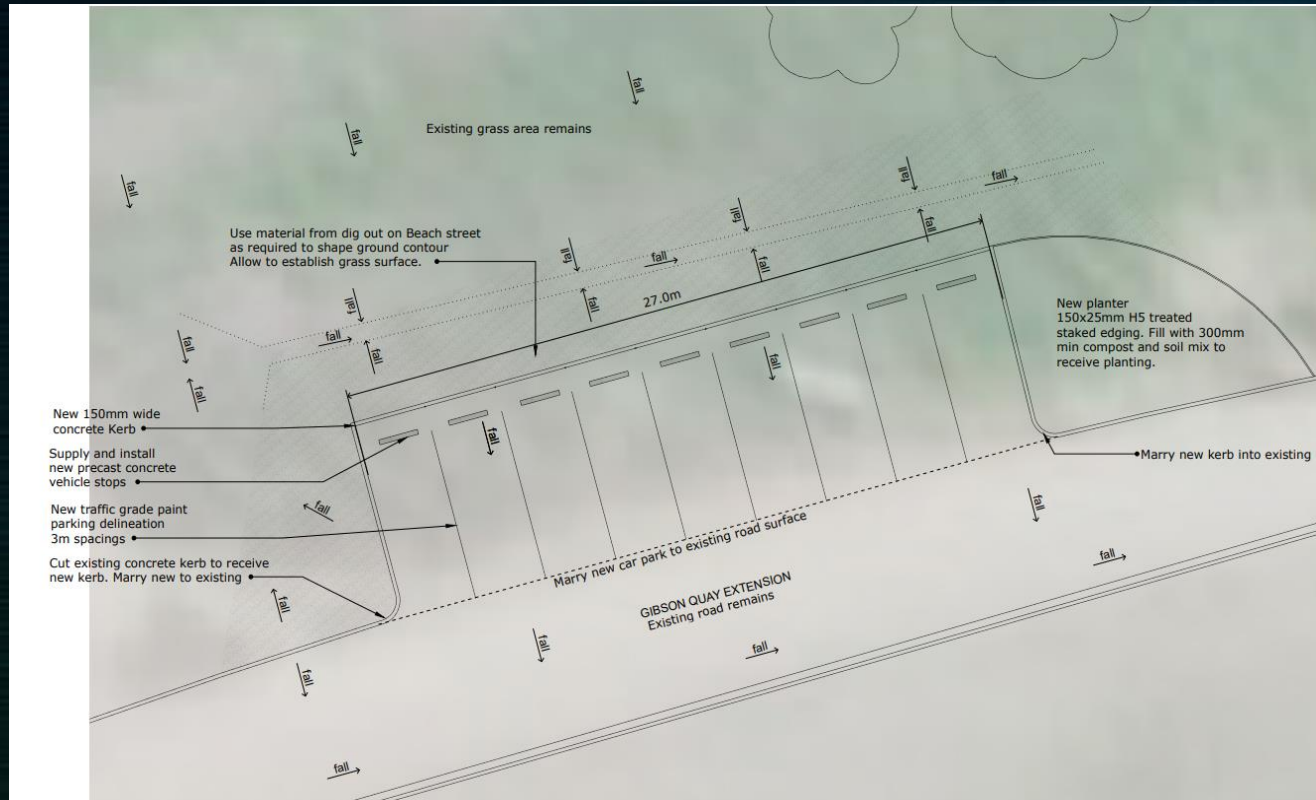

Located at Sunset Point before the toilets, on the beach side.

Another 8m deep chip seal car park to match the existing car park near the toilets. Constructed deeper to allow for increased campervan visitation. Kerb installed on three sides and the car park surface water will flow into the existing road on sunset point.

The opportunity to fix the surface water scour on the hill will be taken as landscape works allow to form better drainage along the length of the car parking area